

All dimensions to be checked on site. Figured dimensions take preference over scaled dimensions. Any errors or discrepancies to be reported to the Architects. This drawing may not be edited or modified by the recipient.

Copyright and ownership of this drawing is vested in RKD Architects, whose prior written consent is required for its use, reproduction or for publication to any third party. All rights reserved by the law of copyright and by international copyright conventions are reserved to RKD Architects and may be protected by court proceedings for damages and/or injunctions and costs.

RKD Architects' Quality Management Systems are certified to ISO 9001:2015.

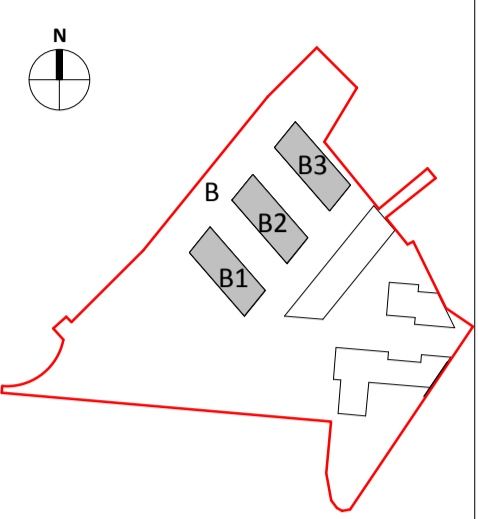

- Notes:**
- All levels shown are to the Irish Transverse Mercator (ITM) and are displayed in meters (m).
 - All levels shown relate to the Malin Head datum.
 - All dimensions shown in millimeters (mm)
 - Symbol indicates top of floor level and relates to Malin Head datum
- USE**
- STUDIO APARTMENT
 - 1 BED APARTMENT
 - 2 BED APARTMENT
 - 3 BED APARTMENT
 - INTERNAL RESIDENTIAL AMENITIES
 - RETAIL
 - COMMUNITY
 - ANCILLARY USE



1 BLOCK B PLAN_LEVEL 13
1 : 200

| Rev. | Date | Description |
|------|----------|--|
| A | OCT 2019 | Issued for Planning Application Submission |

STATUS PLANNING
PROJECT THE CONNOLLY QUARTER
PROJECT ADDRESS Lands to the Rear of Connolly Station, Dublin 1
DWG TITLE BLOCK B PLAN_LEVEL 13
DWG NO. 18135-RKD-B-13-DR-A-1113

| REV. | PROJECT NO. | SCALE |
|------|-------------|---------|
| A | 18135 | 1 : 200 |

RKD
 59 Northumberland Rd
 Ballsbridge, Dublin 4
 D04 W P96, Ireland

ARROW
 Name: Farnagagade 13, st m
 DK-1364 Copenhagen K
 Denmark